

K06 TYPE -40°C +85°C 5000H

RoHS Compliant

- Surge-proof capacitor in aluminium can with insulation sleeve
- Safety vent at bottom case or aside case.
- Snap in terminals for PCB mounting.
- Very high CV for unit volume with low ESR.
- High ripple current, in small dimensions case size.
- Operation up to 105°C permissible..

APPLICATIONS

Professional switch mode power supplies. Professional power electronics.

Dimensions in mm.

Circuit board hole dimensions

2 PIN CAPACITOR

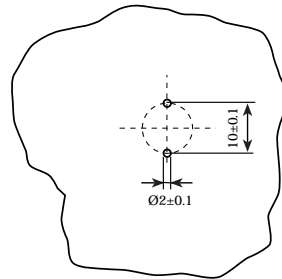
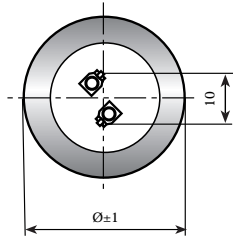
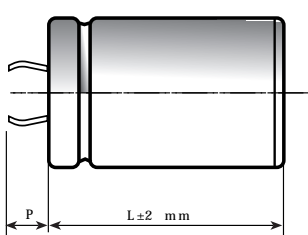

PIN LENGTH
 P 4.5 short pin
 P 6.3 long pin (standard)

3 PIN CAPACITOR

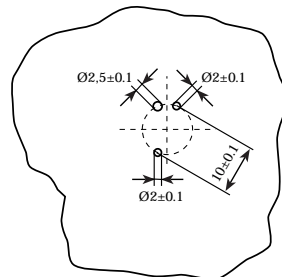
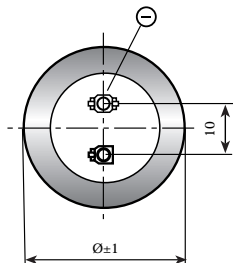
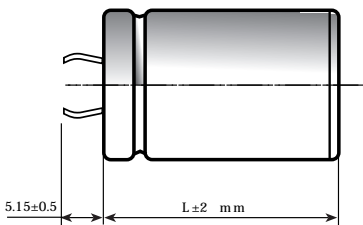

4 PIN CAPACITOR

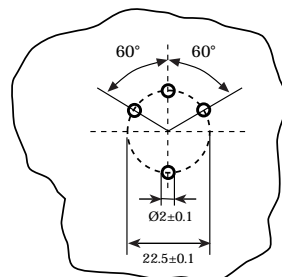
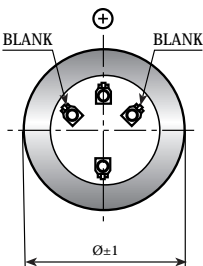
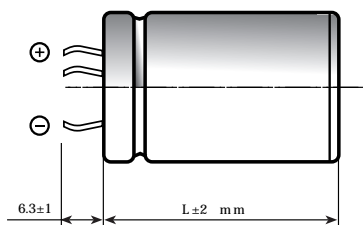

| Ø | 22 | 25 | 30 | 35 | 40 | 45 | 50 |
|--------|----|----|----|----|----|----|----|
| 2 PINS | ● | ● | ● | ● | ● | | |
| 3 PINS | | ● | ● | ● | | | |
| 4 PINS | | | | ● | ● | ● | ● |

On demand, only for capacitors with diam ≥ 35mm: octagonal can shape for long stress vibration applications

SPECIFICATIONS

| | | |
|--|--|--|
| Temperature Range | Operating: -40°C +85°C Storage : Preferably below +25°C, not exceeding +40°C | [Environmental classification 40/85/56 IEC-68] |
| Rated Voltage Range (V_r) | from 16V to 600V DC | |
| Surge Voltage (V_p) | $V_p = 1.05 V_r$ ($V_r > 450V$ DC) $V_p = 1.15 V_r$ ($V_r \leq 250V$ DC) $V_p = 1.10 V_r$ ($V_r > 250V$ DC) | |
| Rated Capacitance Range | from 68 μ F to 33,000 μ F | |
| Capacitance Tolerance | $\pm 20\%$ at 100 Hz, 20°C [M class IEC-62] | |
| Leakage Current (I_L) (mA, 5 min, 20°C) | max $I_L = 0.006 C_r V_r + 4 \mu$ A Kendeil product limit : $I_L = 0.003 C_r V_r$ At 85°C max $I_L = 0.04 C_r V_r \mu$ A | |
| Ripple current (I_r) | Refer to table at 85°C and 100Hz For different temperature and frequency multiplier must be used as follows: | |
| | FREQUENCY | 50Hz 100Hz 500 Hz 1000Hz >10kHz |
| | MULTIPLIER (0-25V V_r DC) | 0.91 1.0 1.15 1.15 1.2 |
| | MULTIPLIER (40-100V V_r DC) | 0.88 1.0 1.35 1.40 1.45 |
| | MULTIPLIER (160-450V V_r DC) | 0.88 1.0 1.45 1.50 1.55 |
| | AMBIENT TEMP. | 35°C 45°C 55°C 65°C 75°C 85°C 95°C |
| | MULTIPLIER | 2.2 2.1 1.8 1.6 1.4 1.0 0.5 |
| | Maximum internal temperature | 98°C |
| Insulation Resistance | At 100V DC for 1 min is $>100 M\Omega$ across insulating sleeve and terminals. | |
| Vibration Resistance | Frequency range: 10 Hz to 500 Hz, amplitude 0.75 mm max acceleration 10g for 3x2 h | |
| Life test | After 2,000 hours application of rated voltage at 85°C capacitors meet characteristics aside | Cap change $\leq 20\%$ tan $\delta \leq 200\%$ Leakage current (I_L) $<$ initial limit Impedance (Z) $\leq 200\%$ |
| Shelf life | After leaving capacitors under no load for 500 hours at 85°C, when restored at 20°C meet specifications aside | Cap change $\leq \pm 15\%$ tan $\delta \leq 150\%$ Leakage current (I_L) $<$ initial limit |
| Useful life (V_n , Temp rated I ripple applied) | $> 200,000$ h at 40°C $> 5,000$ h at 85°C | |
| Failure percentage Failure rate | $\leq 1\%$ (during useful life) ≤ 25 fit ($25 \cdot 10^{-9}/h$) ($V_r \leq 160V$ DC) ≤ 33 fit ($33 \cdot 10^{-9}/h$) ($V_r > 160V$ DC) | |
| Self inductance | Approx. 20 nH | |
| Reference standards | CECC 30.301 - IEC 60384-4 LONG LIFE GRADE | |

K06 TYPE STANDARD RATINGS

| Cap μF | $\varnothing \times L$ mm | Tan δ MAX 100 Hz 20°C | ESR TYP m Ω 100 Hz 20°C | Z TYP m Ω 10 kHz 20°C | Ir a.c. A max 100 Hz 85°C | PART NUMBER termination digit excluded |
|----------------------|------------------------------|---------------------------------------|---|---------------------------------------|------------------------------------|--|
| 4700 | 22x30 | 0.30 | 55 | 40 | 1.5 | K06016472_PM0B030 |
| 6800 | 22x30 | 0.30 | 45 | 38 | 1.8 | K06016682_PM0B030 |
| 10000 | 25x30 | 0.40 | 40 | 35 | 2.4 | K06016103_PM0C030 |
| 15000 | 30x30 | 0.45 | 33 | 25 | 2.6 | K06016153_PM0D030 |
| 22000 | 30x40 | 0.60 | 27 | 22 | 3.5 | K06016223_PM0D040 |
| 22000 | 35x30 | 0.60 | 27 | 22 | 3.5 | K06016223_PM0E030 |
| 22000 | 35x40 | 0.60 | 27 | 22 | 3.5 | K06016223_PM0E040 |
| 33000 | 35x50 | 0.70 | 25 | 20 | 4.8 | K06016333_PM0E050 |
| 47000 | 35x50 | 0.90 | 22 | 20 | 5.8 | K06016473_PM0E050 |

RATED
VOLTAGE
VDC

16V

| Cap μF | $\varnothing \times L$ mm | Tan δ MAX 100 Hz 20°C | ESR TYP m Ω 100 Hz 20°C | Z TYP m Ω 10 kHz 20°C | Ir a.c. A max 100 Hz 85°C | PART NUMBER termination digit excluded |
|----------------------|------------------------------|---------------------------------------|---|---------------------------------------|------------------------------------|--|
| 4700 | 22x30 | 0.20 | 53 | 45 | 1.8 | K06025472_PM0B030 |
| 6800 | 25x30 | 0.25 | 50 | 38 | 2.7 | K06025682_PM0C030 |
| 10000 | 25x40 | 0.40 | 40 | 35 | 3.3 | K06025103_PM0C040 |
| 10000 | 30x30 | 0.40 | 40 | 35 | 3.3 | K06025103_PM0D030 |
| 15000 | 30x40 | 0.45 | 39 | 28 | 4.1 | K06025153_PM0D040 |
| 15000 | 35x30 | 0.45 | 39 | 28 | 4.1 | K06025153_PM0E030 |
| 22000 | 35x40 | 0.60 | 30 | 22 | 5.0 | K06025223_PM0E040 |
| 33000 | 35x50 | 0.70 | 22 | 18 | 6.1 | K06025333_PM0E050 |

RATED
VOLTAGE
VDC

25V

| Cap μF | $\varnothing \times L$ mm | Tan δ MAX 100 Hz 20°C | ESR TYP m Ω 100 Hz 20°C | Z TYP m Ω 10 kHz 20°C | Ir a.c. A max 100 Hz 85°C | PART NUMBER termination digit excluded |
|----------------------|------------------------------|---------------------------------------|---|---------------------------------------|------------------------------------|--|
| 3300 | 22x30 | 0.15 | 72 | 58 | 2.1 | K06040332_PM0B030 |
| 4700 | 25x30 | 0.20 | 50 | 38 | 2.8 | K06040472_PM0C030 |
| 6800 | 25x40 | 0.30 | 48 | 33 | 3.4 | K06040682_PM0C040 |
| 6800 | 30x30 | 0.30 | 48 | 33 | 3.4 | K06040682_PM0D030 |
| 10000 | 25x40 | 0.40 | 38 | 28 | 3.8 | K06040103_PM0C040 |
| 10000 | 30x40 | 0.40 | 39 | 28 | 4.3 | K06040103_PM0D040 |
| 10000 | 35x30 | 0.40 | 39 | 28 | 4.3 | K06040103_PM0E030 |
| 15000 | 30x40 | 0.45 | 32 | 22 | 4.0 | K06040153_PM0D040 |
| 15000 | 35x40 | 0.45 | 32 | 22 | 4.8 | K06040153_PM0E040 |
| 22000 | 35x50 | 0.60 | 28 | 20 | 5.4 | K06040223_PM0E050 |

RATED
VOLTAGE
VDC

40V

K06 TYPE STANDARD RATINGS

| Cap μF | \varnothing x L mm | Tan δ MAX 100 Hz 20°C | ESR TYP m Ω 100 Hz 20°C | Z TYP m Ω 10 kHz 20°C | Ir a.c. A max 100 Hz 85°C | PART NUMBER termination digit excluded |
|----------------------|-------------------------|---------------------------------------|---|---------------------------------------|------------------------------------|--|
| 2200 | 22x30 | 0.20 | 72 | 58 | 1.9 | K06050222_PM0B030 |
| 3300 | 25x30 | 0.20 | 48 | 38 | 2.5 | K06050332_PM0C030 |
| 4700 | 25x30 | 0.20 | 50 | 35 | 2.8 | K06050472_PM0C030 |
| 6800 | 25x40 | 0.30 | 48 | 28 | 3.2 | K06050682_PM0C040 |
| 6800 | 30x30 | 0.30 | 48 | 28 | 3.2 | K06050682_PM0D030 |
| 10000 | 30x40 | 0.35 | 31 | 22 | 3.8 | K06050103_PM0D040 |
| 10000 | 35x30 | 0.35 | 31 | 28 | 3.8 | K06050103_PM0E030 |
| 10000 | 35x40 | 0.35 | 31 | 28 | 4.1 | K06050103_PM0E040 |
| 15000 | 35x50 | 0.45 | 26 | 18 | 4.9 | K06050153_PM0E050 |
| 22000 | 40x50 | 0.50 | 25 | 18 | 7.3 | K06050223_PM0F050 |

RATED
VOLTAGE
VDC

50V

| Cap μF | \varnothing x L mm | Tan δ MAX 100 Hz 20°C | ESR TYP m Ω 100 Hz 20°C | Z TYP m Ω 10 kHz 20°C | Ir a.c. A max 100 Hz 85°C | PART NUMBER termination digit excluded |
|----------------------|-------------------------|---------------------------------------|---|---------------------------------------|------------------------------------|--|
| 2200 | 25x30 | 0.20 | 79 | 58 | 2.2 | K06063222_PM0C030 |
| 3300 | 25x40 | 0.20 | 50 | 38 | 2.6 | K06063332_PM0C040 |
| 3300 | 30x30 | 0.20 | 50 | 38 | 2.6 | K06063332_PM0D030 |
| 4700 | 25x40 | 0.20 | 41 | 29 | 2.8 | K06063472_PM0C040 |
| 4700 | 30x40 | 0.20 | 41 | 29 | 3.5 | K06063472_PM0D040 |
| 4700 | 35x30 | 0.20 | 41 | 29 | 3.5 | K06063472_PM0E030 |
| 6800 | 30x40 | 0.30 | 35 | 25 | 3.6 | K06063682_PM0D040 |
| 6800 | 35x40 | 0.30 | 35 | 25 | 4.0 | K06063682_PM0E040 |
| 10000 | 35x50 | 0.35 | 32 | 23 | 5.8 | K06063103_PM0E050 |
| 15000 | 40x50 | 0.45 | 30 | 20 | 6.8 | K06063153_PM0F050 |

RATED
VOLTAGE
VDC

63V

| Cap μF | \varnothing x L mm | Tan δ MAX 100 Hz 20°C | ESR TYP m Ω 100 Hz 20°C | Z TYP m Ω 10 kHz 20°C | Ir a.c. A max 100 Hz 85°C | PART NUMBER termination digit excluded |
|----------------------|-------------------------|---------------------------------------|---|---------------------------------------|------------------------------------|--|
| 1000 | 22x30 | 0.12 | 150 | 100 | 1.3 | K06100102_PM0B030 |
| 1000 | 25x30 | 0.12 | 150 | 100 | 1.6 | K06100102_PM0C030 |
| 1000 | 30x25 | 0.12 | 150 | 100 | 1.6 | K06100102_PM0D025 |
| 1500 | 30x30 | 0.12 | 105 | 82 | 2.1 | K06100152_PM0D030 |
| 2200 | 30x30 | 0.15 | 71 | 60 | 2.4 | K06100222_PM0D030 |
| 2200 | 30x40 | 0.15 | 71 | 60 | 3.1 | K06100222_PM0D040 |
| 2200 | 35x30 | 0.15 | 71 | 60 | 2.4 | K06100222_PM0E030 |
| 3300 | 30x50 | 0.20 | 48 | 39 | 4.0 | K06100332_PM0D050 |
| 3300 | 35x40 | 0.20 | 48 | 39 | 4.0 | K06100332_PM0E040 |
| 4700 | 35x50 | 0.20 | 33 | 26 | 5.6 | K06100472_PM0E050 |
| 6800 | 35x50 | 0.25 | 33 | 25 | 5.8 | K06100682_PM0E050 |

RATED
VOLTAGE
VDC

100V

K06 TYPE STANDARD RATINGS

| Cap μF | $\varnothing \times L$ mm | Tan δ MAX 100 Hz 20°C | ESR TYP m Ω 100 Hz 20°C | Z TYP m Ω 10 kHz 20°C | Ir a.c. A max 100 Hz 85°C | PART NUMBER termination digit excluded |
|----------------------|------------------------------|---------------------------------------|---|---------------------------------------|------------------------------------|--|
| 220 | 22x30 | 0.10 | 440 | 340 | 0.9 | K06200221_PM0B030 |
| 330 | 22x30 | 0.10 | 240 | 133 | 1.3 | K06200331_PM0B030 |
| 470 | 25x30 | 0.10 | 169 | 98 | 1.5 | K06200471_PM0C030 |
| 680 | 25x40 | 0.10 | 145 | 87 | 2.0 | K06200681_PM0C040 |
| 680 | 30x30 | 0.10 | 145 | 87 | 2.0 | K06200681_PM0D030 |
| 680 | 35x30 | 0.10 | 145 | 87 | 2.0 | K06200681_PM0E030 |
| 1000 | 30x40 | 0.10 | 95 | 63 | 2.6 | K06200102_PM0D040 |
| 1000 | 35x40 | 0.10 | 95 | 63 | 2.8 | K06200102_PM0E040 |
| 1500 | 35x40 | 0.10 | 70 | 41 | 2.9 | K06200152_PM0E040 |
| 1500 | 35x50 | 0.10 | 70 | 41 | 3.7 | K06200152_PM0E050 |
| 2200 | 35x50 | 0.10 | 45 | 33 | 3.90 | K06200222_PM0E050 |

RATED
VOLTAGE
VDC

200V

| Cap μF | $\varnothing \times L$ mm | Tan δ MAX 100 Hz 20°C | ESR TYP m Ω 100 Hz 20°C | Z TYP m Ω 10 kHz 20°C | Ir a.c. A max 100 Hz 85°C | PART NUMBER termination digit excluded |
|----------------------|------------------------------|---------------------------------------|---|---------------------------------------|------------------------------------|--|
| 150 | 22x30 | 0.12 | 530 | 290 | 0.9 | K06250151_PM0B030 |
| 220 | 25x30 | 0.12 | 370 | 240 | 1.3 | K06250221_PM0C030 |
| 330 | 25x40 | 0.12 | 260 | 153 | 1.4 | K06250331_PM0C040 |
| 330 | 30x30 | 0.12 | 260 | 153 | 1.4 | K06250331_PM0D030 |
| 470 | 25x40 | 0.12 | 180 | 110 | 1.6 | K06250471_PM0C040 |
| 470 | 30x30 | 0.12 | 180 | 110 | 1.6 | K06250471_PM0D030 |
| 680 | 30x40 | 0.12 | 145 | 95 | 1.9 | K06250681_PM0D040 |
| 680 | 35x40 | 0.12 | 145 | 95 | 2.2 | K06250681_PM0E040 |
| 1000 | 35x40 | 0.12 | 98 | 65 | 2.6 | K06250102_PM0E040 |
| 1000 | 35x50 | 0.12 | 98 | 65 | 3.20 | K06250102_PM0E050 |
| 1500 | 35x50 | 0.15 | 75 | 43 | 4.00 | K06250152_PM0E050 |
| 2200 | 40x50 | 0.15 | 50 | 35 | 5.20 | K06250222_PM0F050 |

RATED
VOLTAGE
VDC

250V

K06 TYPE STANDARD RATINGS

| Cap μF | $\varnothing \times L$ mm | Tan δ MAX 100 Hz 20°C | ESR TYP m Ω 100 Hz 20°C | Z TYP m Ω 10 kHz 20°C | Ir a.c. A max 100 Hz 85°C | PART NUMBER termination digit excluded |
|----------------------|------------------------------|---------------------------------------|---|---------------------------------------|------------------------------------|--|
| 68 | 22x25 | 0.10 | 1405 | 1050 | 0.6 | K06400680_PM0B025 |
| 68 | 22x30 | 0.10 | 1405 | 1050 | 0.6 | K06400680_PM0B030 |
| 100 | 22x30 | 0.10 | 796 | 550 | 0.7 | K06400101_PM0B030 |
| 100 | 25x25 | 0.10 | 796 | 550 | 0.7 | K06400101_PM0C025 |
| 100 | 25x30 | 0.10 | 796 | 550 | 1.0 | K06400101_PM0C030 |
| 150 | 25x30 | 0.10 | 530 | 380 | 1.0 | K06400151_PM0C030 |
| 150 | 30x25 | 0.10 | 530 | 380 | 1.0 | K06400151_PM0D025 |
| 220 | 25x40 | 0.10 | 360 | 250 | 1.2 | K06400221_PM0C040 |
| 220 | 30x30 | 0.10 | 360 | 250 | 1.2 | K06400221_PM0D030 |
| 330 | 30x40 | 0.10 | 240 | 170 | 1.7 | K06400331_PM0D040 |
| 330 | 35x30 | 0.10 | 240 | 170 | 1.7 | K06400331_PM0E030 |
| 470 | 35x40 | 0.10 | 170 | 125 | 2.2 | K06400471_PM0E040 |
| 470 | 35x50 | 0.10 | 170 | 125 | 2.60 | K06400471_PM0E040 |
| 560 | 35x50 | 0.10 | 165 | 122 | 2.60 | K06400561_PM0E050 |
| 680 | 35x50 | 0.10 | 158 | 110 | 2.80 | K06400681_PM0E050 |
| 680 | 40x50 | 0.10 | 158 | 110 | 3.20 | K06400681_PM0F050 |
| 820 | 35x60 | 0.10 | 140 | 106 | 3.50 | K06400821_PM0E060 |
| 1000 | 35x60 | 0.12 | 103 | 91 | 4.40 | K06400102_PM0E060 |
| 1500 | 40x97 | 0.12 | 65 | 50 | 5.79 | K06400152_PM0F097 |

RATED
VOLTAGE
VDC

400V

| Cap μF | $\varnothing \times L$ mm | Tan δ MAX 100 Hz 20°C | ESR TYP m Ω 100 Hz 20°C | Z TYP m Ω 10 kHz 20°C | Ir a.c. A max 100 Hz 85°C | PART NUMBER termination digit excluded |
|----------------------|------------------------------|---------------------------------------|---|---------------------------------------|------------------------------------|--|
| 68 | 22x25 | 0.12 | 1405 | 1050 | 0.6 | K06450680_PM0B025 |
| 68 | 22x30 | 0.12 | 1405 | 1050 | 0.6 | K06450680_PM0B030 |
| 100 | 25x30 | 0.12 | 800 | 560 | 0.7 | K06450101_PM0C030 |
| 100 | 30x25 | 0.12 | 800 | 560 | 0.7 | K06450101_PM0D025 |
| 150 | 30x25 | 0.12 | 550 | 400 | 1.1 | K06450151_PM0D025 |
| 150 | 30x30 | 0.12 | 550 | 400 | 1.1 | K06450151_PM0D030 |
| 220 | 30x40 | 0.12 | 380 | 265 | 1.3 | K06450221_PM0D040 |
| 220 | 35x30 | 0.12 | 380 | 265 | 1.3 | K06450221_PM0E030 |
| 330 | 30x50 | 0.12 | 255 | 175 | 1.7 | K06450331_PM0D050 |
| 330 | 35x40 | 0.12 | 255 | 175 | 1.7 | K06450331_PM0E040 |
| 470 | 35x50 | 0.12 | 175 | 125 | 2.40 | K06450471_PM0E050 |
| 560 | 35x50 | 0.12 | 165 | 122 | 2.50 | K06450561_PM0E050 |
| 680 | 35x50 | 0.12 | 158 | 110 | 2.60 | K06450681_PM0E050 |
| 680 | 40x50 | 0.12 | 158 | 110 | 3.10 | K06450681_PM0F050 |
| 820 | 40x60 | 0.12 | 110 | 95 | 4.00 | K06450821_PM0F060 |
| 1000 | 40x77 | 0.12 | 110 | 95 | 4.90 | K06450102_PM0F077 |
| 1500 | 40x97 | 0.12 | 110 | 95 | 5.56 | K06450152_PM0F097 |

RATED
VOLTAGE
VDC

450V

K06 TYPE STANDARD RATINGS

| Cap μF | $\varnothing \times L$ mm | Tan δ MAX 100 Hz 20°C | ESR TYP m Ω 100 Hz 20°C | Z TYP m Ω 10 kHz 20°C | Ir a.c. A max 100 Hz 85°C | PART NUMBER termination digit excluded |
|----------------------|------------------------------|---------------------------------------|---|---------------------------------------|------------------------------------|--|
| 68 | 25x30 | 0.15 | 1870 | 1380 | 0.60 | K06500680_PM0C030 |
| 100 | 30x30 | 0.15 | 1050 | 790 | 0.70 | K06500101_PM0D030 |
| 150 | 30x40 | 0.15 | 750 | 580 | 1.10 | K06500151_PM0D040 |
| 220 | 30x50 | 0.15 | 579 | 440 | 1.40 | K06500221_PM0D050 |
| 220 | 35x40 | 0.15 | 579 | 440 | 1.40 | K06500221_PM0E040 |
| 330 | 35x50 | 0.15 | 386 | 290 | 2.10 | K06500331_PM0E050 |
| 470 | 40x50 | 0.15 | 271 | 200 | 2.50 | K06500471_PM0F050 |
| 560 | 40x60 | 0.15 | 230 | 190 | 3.00 | K06500561_PM0F060 |
| 680 | 40x77 | 0.15 | 205 | 155 | 3.50 | K06500681_PM0F077 |
| 820 | 40x97 | 0.15 | 141 | 119 | 3.90 | K06500821_PM0F097 |
| 1000 | 40x77 | 0.15 | 135 | 112 | 4.00 | K06500102_PM0F077 |
| 1200 | 40x97 | 0.15 | 125 | 105 | 4.90 | K06500122_PM0F097 |
| 1500 | 45x97 | 0.15 | 115 | 98 | 5.14 | K06500152_PM0N097 |

RATED
VOLTAGE
VDC

500V

| Cap μF | $\varnothing \times L$ mm | Tan δ MAX 100 Hz 20°C | ESR TYP m Ω 100 Hz 20°C | Z TYP m Ω 10 kHz 20°C | Ir a.c. A max 100 Hz 85°C | PART NUMBER termination digit excluded |
|----------------------|------------------------------|---------------------------------------|---|---------------------------------------|------------------------------------|--|
| 68 | 25x30 | 0.15 | 1898 | 1443 | 0.75 | K06550680_PM0C030 |
| 100 | 30x30 | 0.15 | 1271 | 970 | 0.95 | K06550101_PM0D030 |
| 150 | 30x40 | 0.15 | 879 | 670 | 1.20 | K06550151_PM0D040 |
| 180 | 30x50 | 0.15 | 722 | 550 | 1.40 | K06550181_PM0D050 |
| 180 | 35x40 | 0.15 | 722 | 550 | 1.41 | K06550181_PM0E040 |
| 220 | 35x40 | 0.15 | 584 | 445 | 1.55 | K06550221_PM0E040 |
| 270 | 35x50 | 0.15 | 491 | 377 | 1.70 | K06550271_PM0E050 |
| 330 | 35x60 | 0.15 | 400 | 306 | 2.45 | K06550331_PM0E060 |
| 330 | 40x50 | 0.15 | 409 | 316 | 2.45 | K06550331_PM0F050 |
| 470 | 40x60 | 0.15 | 290 | 223 | 2.62 | K06550471_PM0F060 |
| 560 | 40x77 | 0.15 | 234 | 180 | 3.10 | K06550561_PM0F077 |
| 680 | 40x97 | 0.15 | 192 | 147 | 3.70 | K06550681_PM0F097 |

RATED
VOLTAGE
VDC

550V

| Cap μF | $\varnothing \times L$ mm | Tan δ MAX 100 Hz 20°C | ESR TYP m Ω 100 Hz 20°C | Z TYP m Ω 10 kHz 20°C | Ir a.c. A max 100 Hz 85°C | PART NUMBER termination digit excluded |
|----------------------|------------------------------|---------------------------------------|---|---------------------------------------|------------------------------------|--|
| 82 | 30x30 | 0.15 | 1427 | 1020 | 0.88 | K06600820_PM0D030 |
| 100 | 30x40 | 0.15 | 1152 | 902 | 1.07 | K06600101_PM0D040 |
| 150 | 30x50 | 0.15 | 820 | 630 | 1.32 | K06600151_PM0D050 |
| 150 | 35x40 | 0.15 | 820 | 630 | 1.34 | K06600151_PM0E040 |
| 220 | 35x50 | 0.15 | 574 | 415 | 1.87 | K06600221_PM0E050 |
| 270 | 35x60 | 0.15 | 474 | 353 | 2.25 | K06600271_PM0E060 |
| 270 | 40x50 | 0.15 | 474 | 353 | 2.25 | K06600271_PM0F050 |
| 330 | 40x60 | 0.15 | 387 | 280 | 2.42 | K06600331_PM0F060 |
| 470 | 40x77 | 0.15 | 277 | 193 | 2.95 | K06600471_PM0F077 |
| 560 | 40x97 | 0.15 | 229 | 179 | 3.50 | K06600561_PM0F097 |

RATED
VOLTAGE
VDC

600V